

ACTIVITY 4

Wednesday

20th January

2021

Alton ACTION



UCL



Results

**Discussing
preliminary
design proposals
for the People's
Plan**

What we have done so far

1. October: Launch event
2. November: Co-assessing the impact of regeneration on residents
3. December: Co-designing proposals

What you have told us

SUMMARY MAP

POTENTIAL SPACE FOR A NEW
HEALTH CENTRE

NEW SHOPS AND WORKSPACES
WITH HOUSING ON TOP

TO BE IMPROVED AS A PLAY SPACE

POTENTIAL SPACE FOR INFILL
HOUSING ON TOP (DARA CLUB)

EXTENSION OF THE EXISTING
MAISONNETTES

- Extension of the existing building for infill housing
- Potential area for infill housing
- Potential space for community facilities
- Potential space for new shops and workspaces
- Play areas + green spaces to be improved
- Re-configuration of existing asset
- Masterplan Area (Existing)

HOPPER BUS AROUND
THE ESTATE

RE-OPENING THE OLD
YOUTH CLUB

HIGH STREET RE-BUMP

GREEN BUFFER TO
PROTECT FROM STREET

MEDIUM-SIZED GROCERY
SHOP WITH HOUSING ON
TOP

DEDICATE SPACES FOR
WALKING DOGS

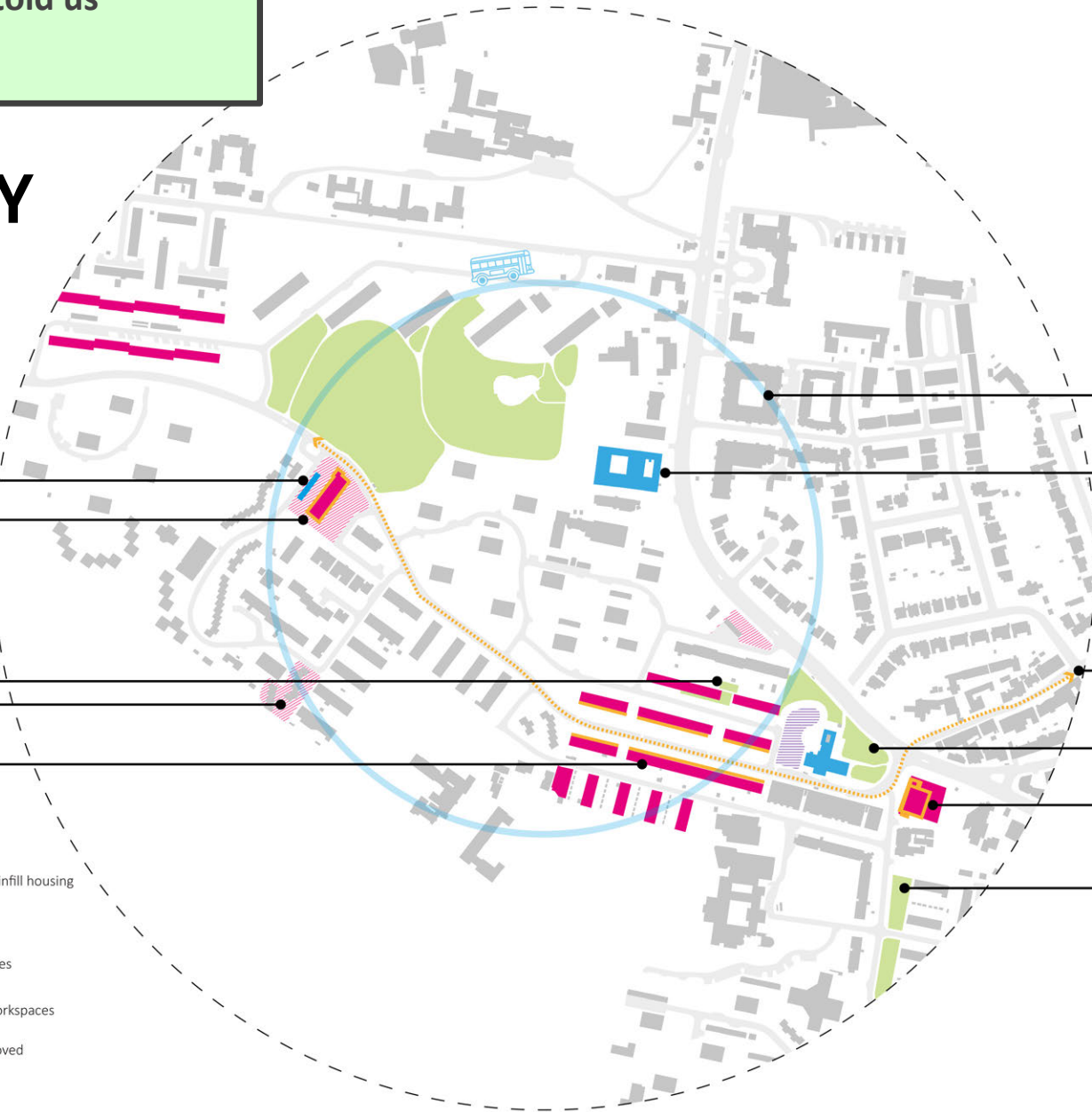

Preliminary proposal for a People's Plan

* The proposal will keep all the existing trees. Some have not been drawn for the clarity of the image

- New Residential
- New Lift Access
- Community Space
- New, Refurbished or Extended Retail
- Supermarket
- Live-in Entrepreneurs' Studios
- Co-working Office Space
- Underground Parking



Flexible public space with sport and youth facilities

New design for Village Green with more space for sitting and gathering

A new high street in Danebury Avenue with shops, co-working and community spaces

New intergenerational outdoor spaces in Roehampton Rocks: play, allotments.

Golf Course / Richmond Park

New public spaces in Portwood Place associated with community facilities and local businesses

New adventure playground for children of different ages

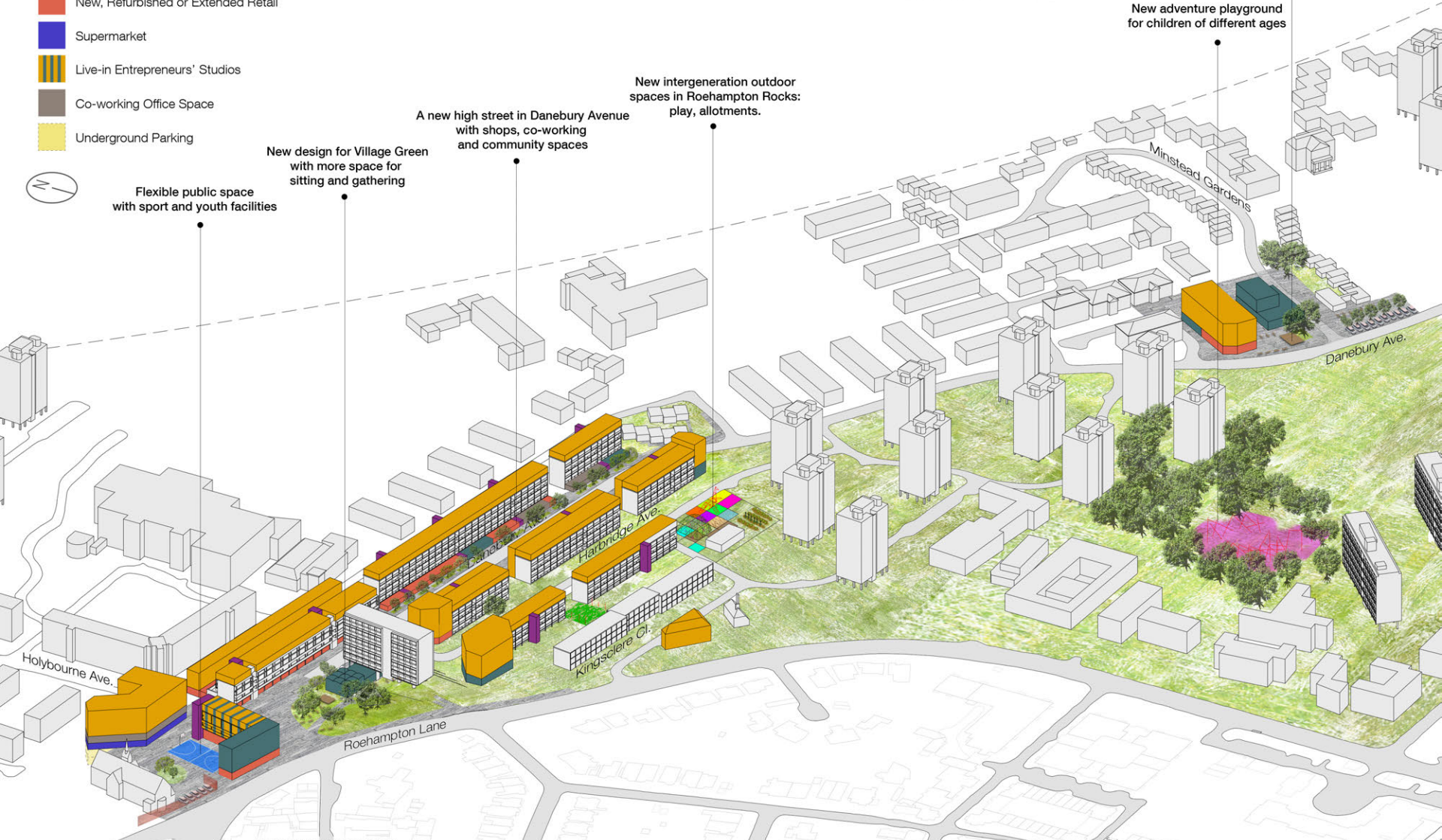

People's vs Council's Plan



Preliminary proposal for a People's Plan

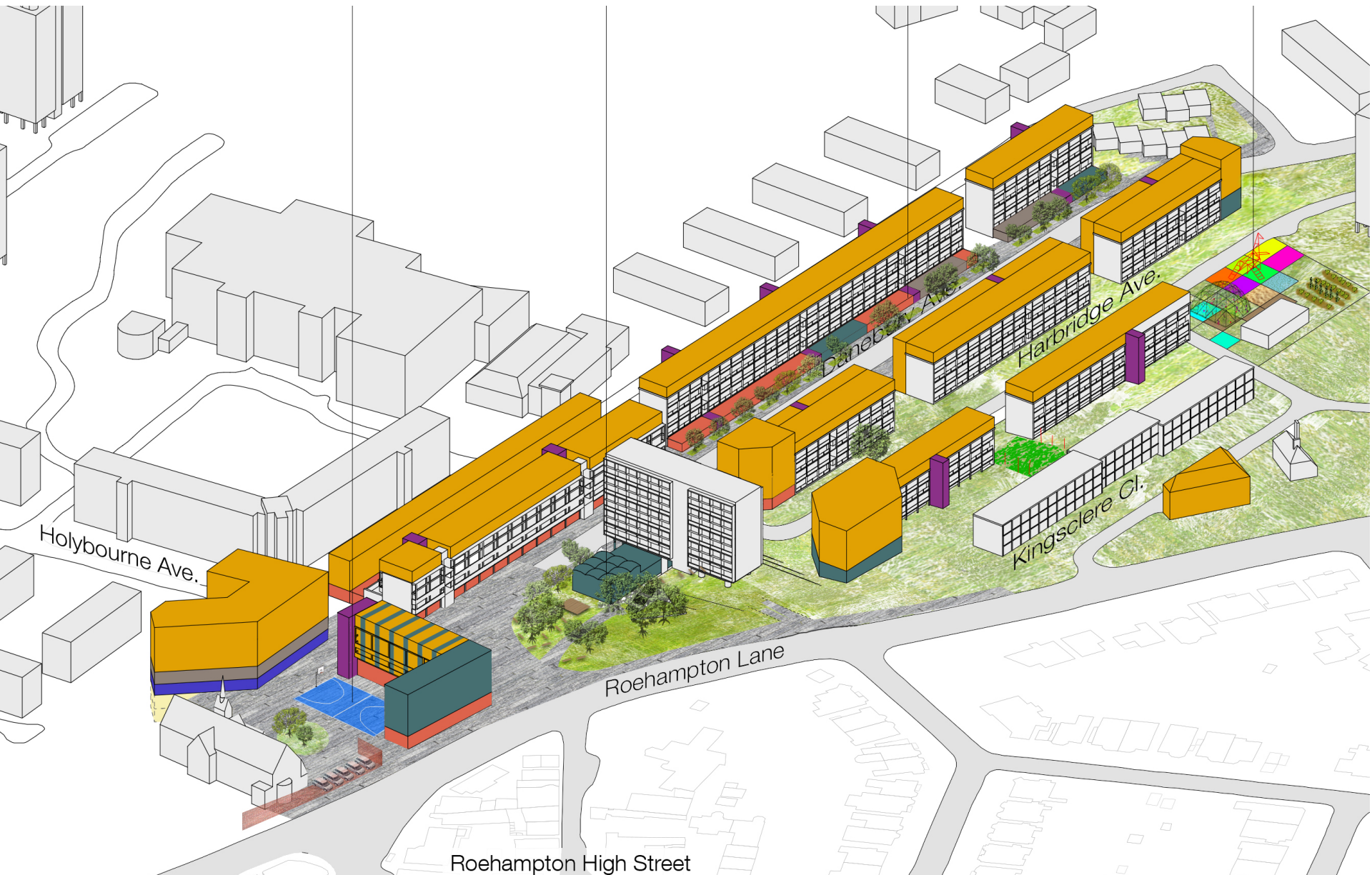

Preliminary proposal for a People's Plan

